





NEW ADDITION



EAST LEFT SIDE



WEST RIGHT SIDE



NORTH FRONT



SOUTH REAR

Site Photos



SOUTH



EAST REAR PORCH



EAST REAR PORCH

Site Photos



HISTORIC NORTH FRONT



HISTORIC WEST RIGHT SIDE

Site Photos

RALPH C. FEY
AIA
ARCHITECTS 04



NEW ADDITION



NEW ADDITION

HISTORIC WEST RIGHT SIDE



Neighbor Across (Right)



Neighbor Across (Left)



Neighbor (Left)



Neighbor (Right)

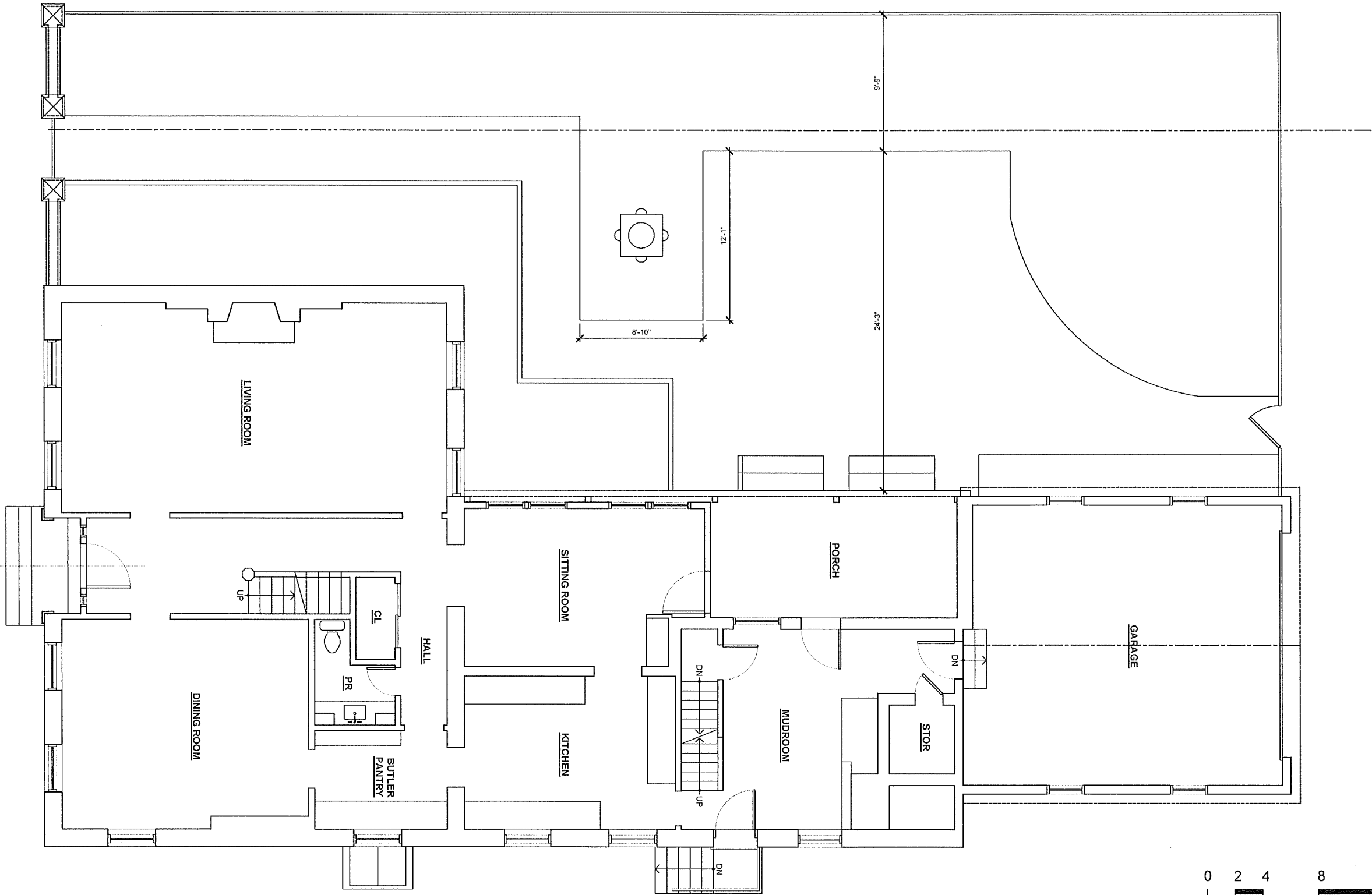
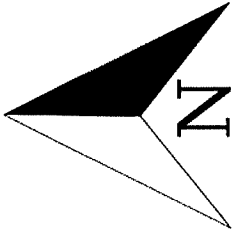

SCALE: 1/8" = 1'-0"

EXISTING FIRST FLOOR PLAN
1/8"=1'

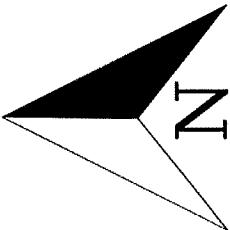
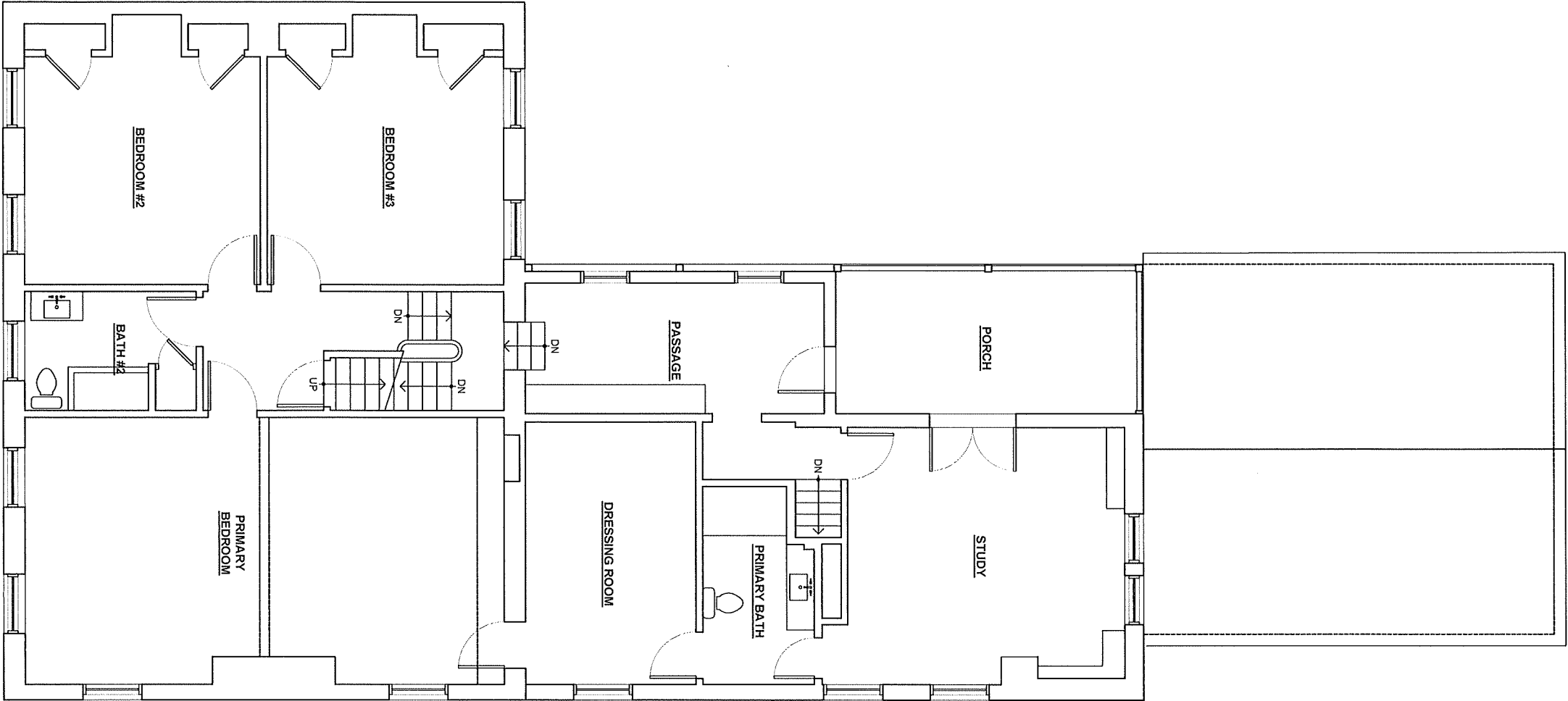

SCALE: 1/8" = 1'-0"

EXISTING SECOND FLOOR PLAN
1/8"=1'



EXISTING EAST ELEVATION
1/8"=1'





EXISTING SOUTH ELEVATION
1/8"=1'

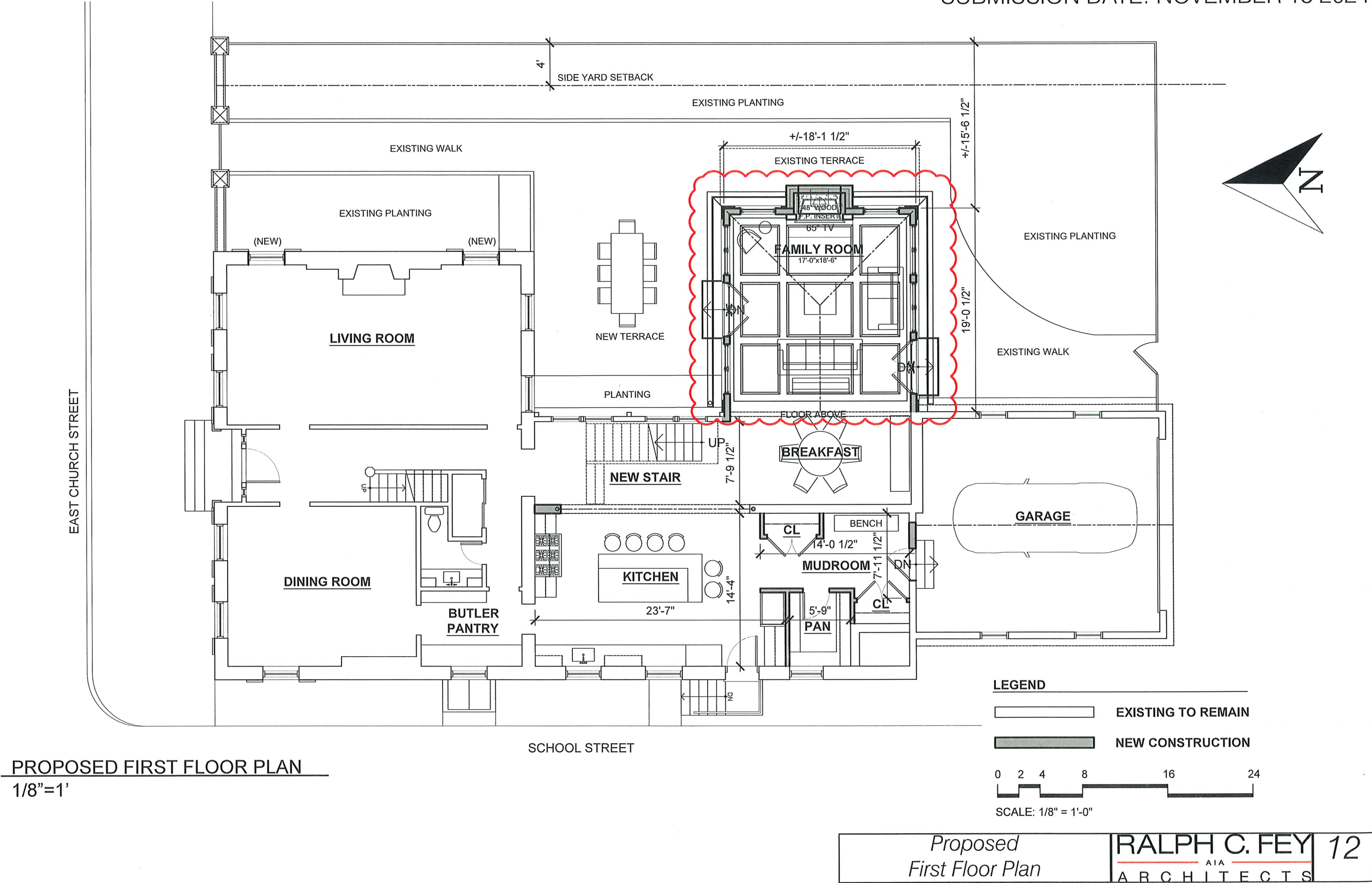

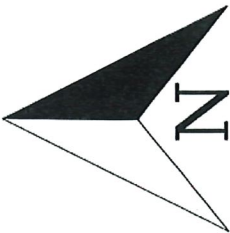

EAST CHURCH STREET

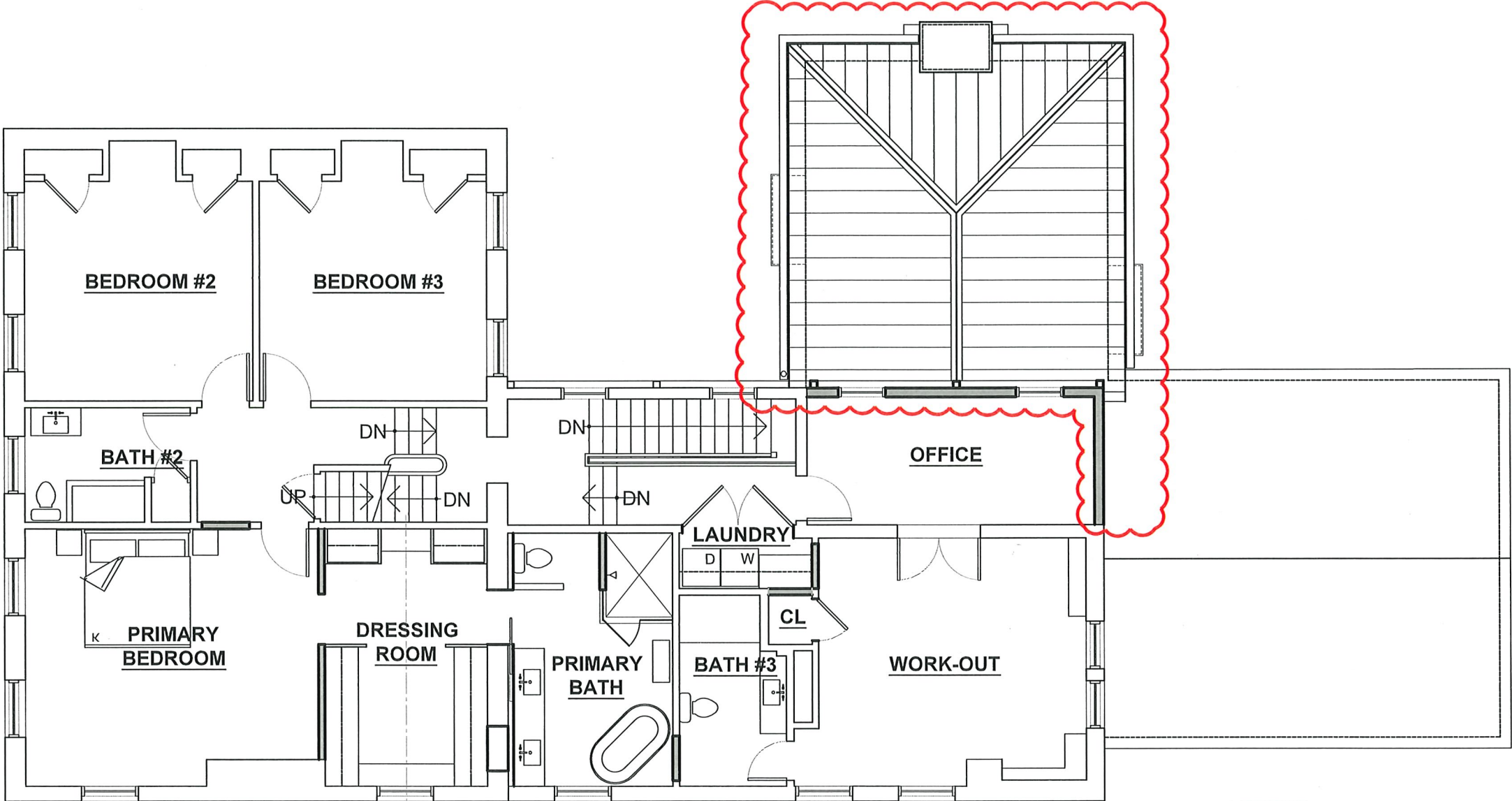

SCHOOL STREET

LEGEND

- EXISTING TO REMAIN
- NEW CONSTRUCTION



SCALE: 1/8" = 1'-0"

PROPOSED SECOND FLOOR PLAN
1/8"=1'

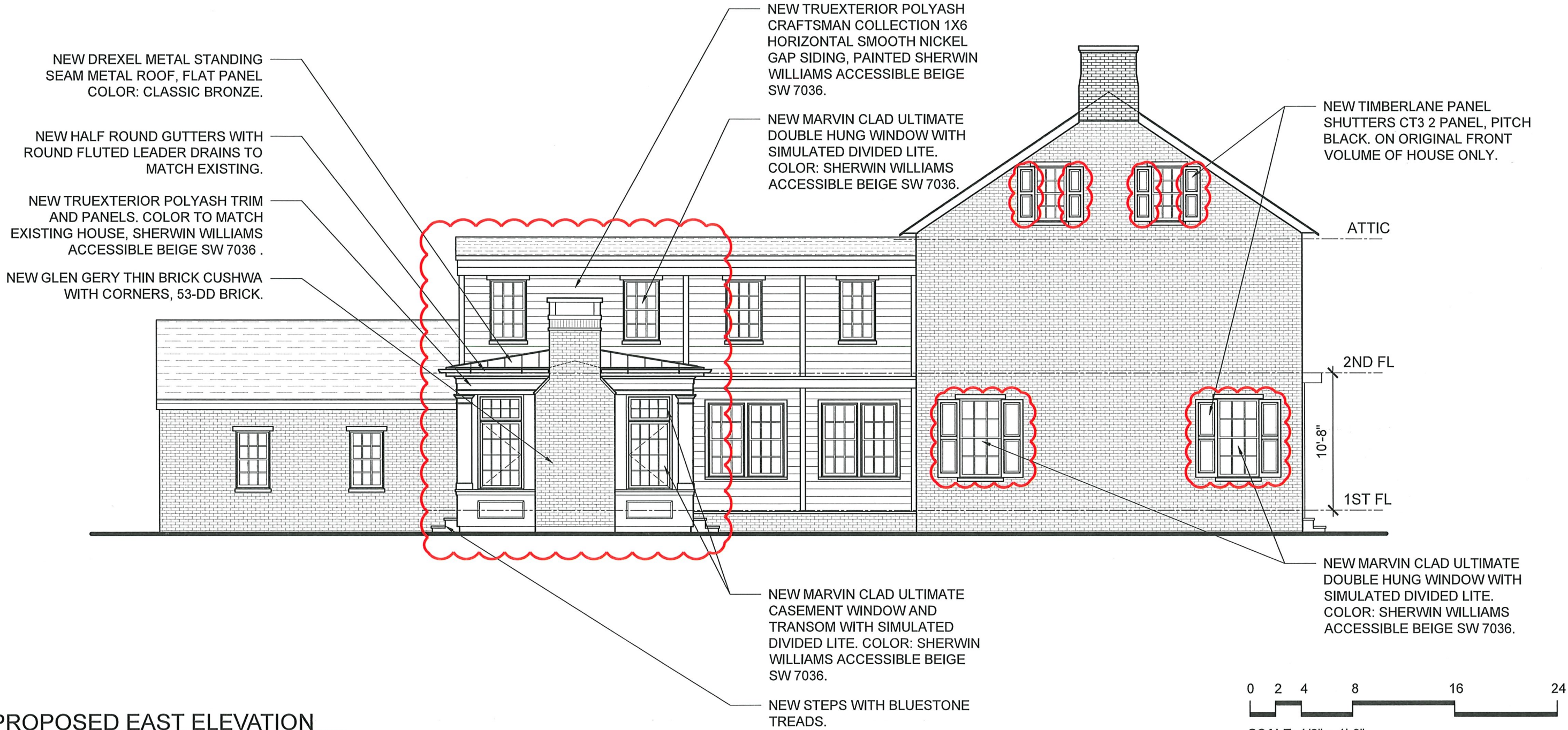

PROPOSED EAST ELEVATION
1/8"=1'

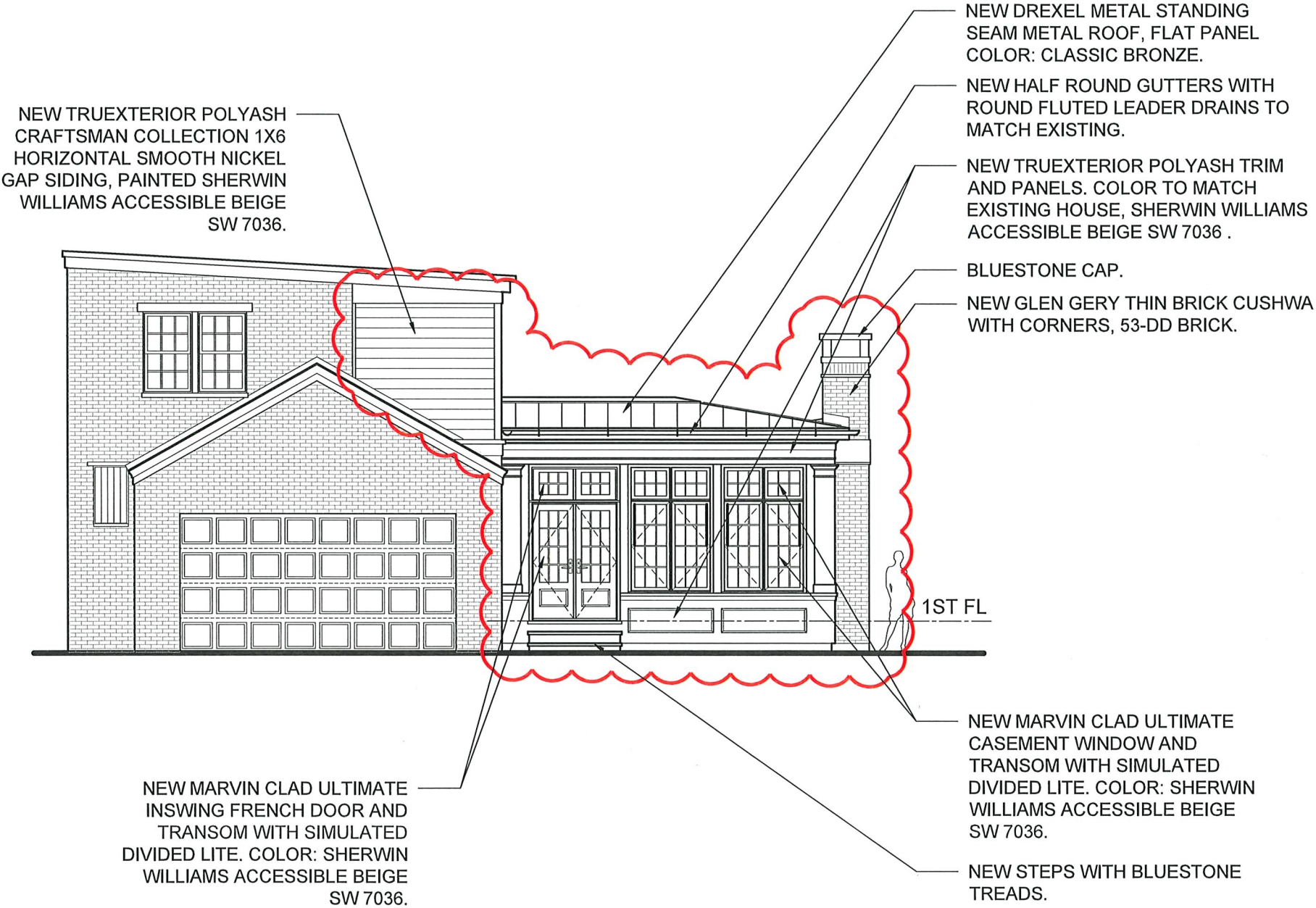

PROPOSED SOUTH ELEVATION
1/8"=1'

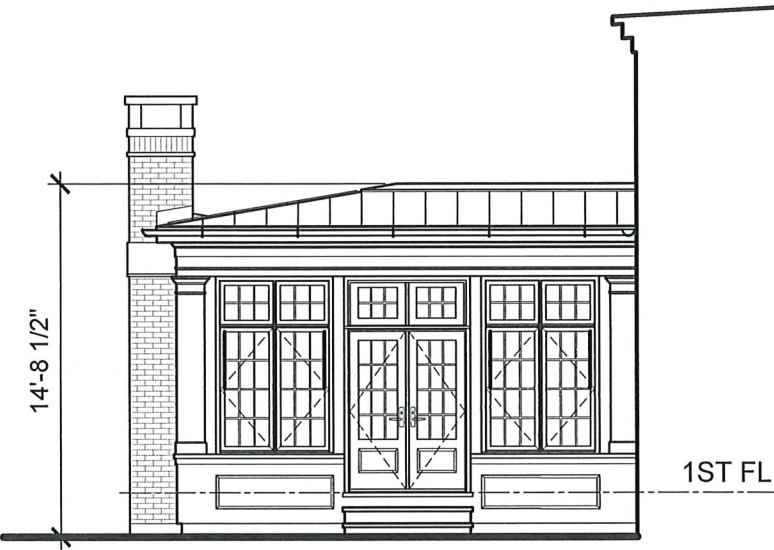

PROPOSED NORTH ELEVATION
1/8"=1'



ULTIMATE DOUBLE HUNG G2

Engineered for performance and designed to inspire, each aspect of the Ultimate Double Hung G2 window was made with purpose. Our engineers consider every detail from the most innovative features to the most minute subtleties, all because the windows in your home help illuminate the most important parts of your life.

INTERIOR FEATURES AND PERFORMANCE

RICH WOOD INTERIOR
Offers beauty and warmth with six wood species and ten interior finish options.

NARROW CHECKRAIL
Provides a sleek aesthetic at 1 15⁄16 inches to maximize daylight opening while maintaining historical accuracy.

TILT WASH MODE
Allows easy access to exterior glass for cleaning and maintenance.

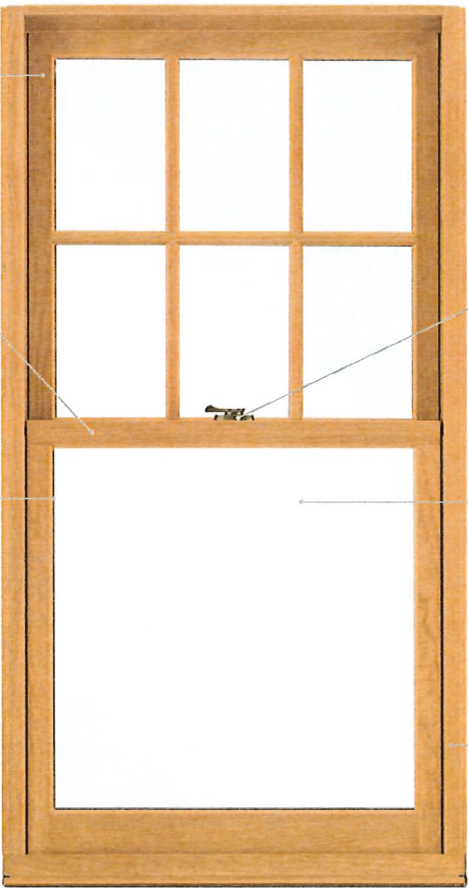

EXCLUSIVE AUTOLOCK
Activates when the sashes are closed, locking the window.

FIRST-RATE ENERGY EFFICIENCY
Meets ENERGY STAR® standards in energy efficiency with multiple glass options for various regions, climates, and weather needs.

SASH BALANCE SYSTEMS
Enables smooth operation at the largest sizes.

EXTERIOR FEATURES AND PERFORMANCE

DURABLE CLADDING
Extruded aluminum exterior cladding with an AAMA verified 2605 finish and backed by a 20-year warranty against chalking and fading.

EXPANSIVE SIZES
Larger than 5 feet wide by 10 feet high.

TRADITIONAL SILL BEVEL
The 14-degree bevel provides optimal water management while maintaining a classic look.

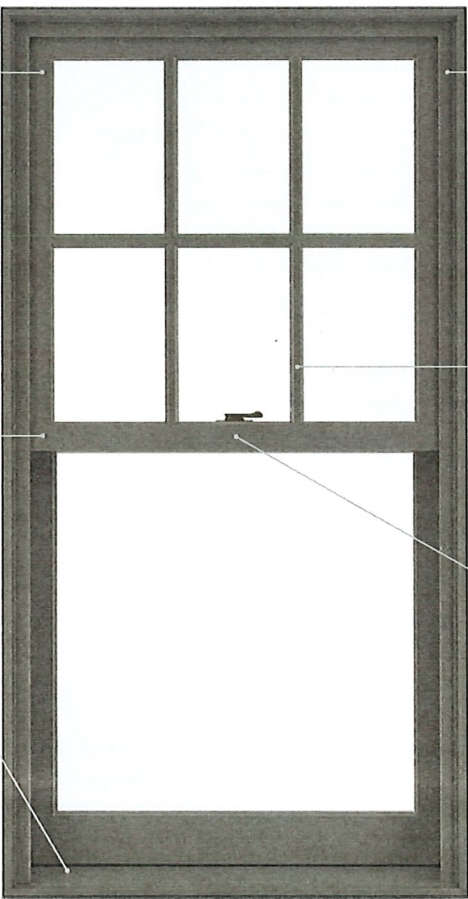

SUPERIOR WEATHER PERFORMANCE
LC-PG50 on most sizes. Optional commercial (CW) performance and IZ3 certified coastal performance on most sizes.

DESIGN VERSATILITY
An array of simulated divided lite patterns, interior and exterior color options, ten hardware finishes, and archtop models.

ALUMINUM INTER-LOCK
Eliminates drafts and improves the window's overall structural integrity.



ULTIMATE CASEMENT

The Ultimate Casement window is offered in some of the largest sizes in the industry, with a secure multi-point lock, durable hardware that ensures smooth operation, and Marvin's exclusive Wash Mode for easy cleaning—even on upper floors. With many design options, including round top shapes, the Ultimate Casement window flexes to fit your vision and can be sized to complement the most expansive views.

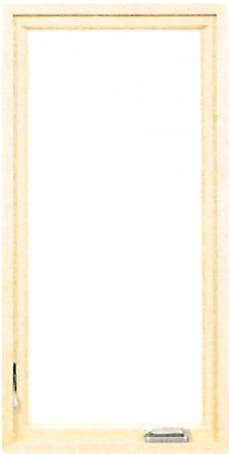

CASEMENT INTERIOR WITH FOLDING HANDLE

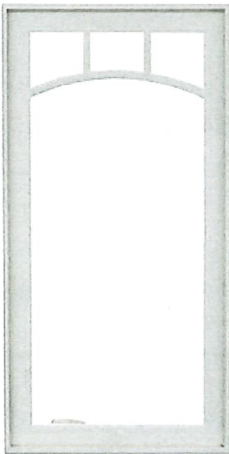

CASEMENT EXTERIOR WITH FOLDING HANDLE



CASEMENT INTERIOR WITH HANDLE IN MATTE BLACK

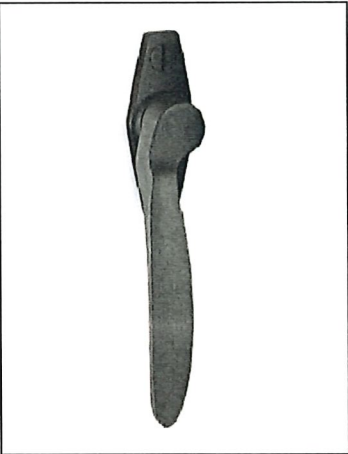



ULTIMATE PICTURE

The Ultimate Picture window offers a classic style in a non-operable window, bringing natural light into a room or highlighting an unobstructed outdoor view. Durable and energy efficient, it can be sized to match accompanying double hung, single hung, or casement windows.

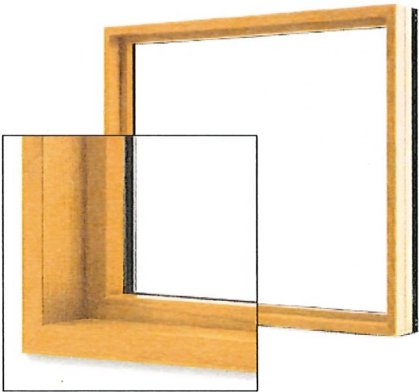

DIRECT GLAZE PICTURE WINDOW
INTERIOR VIEW

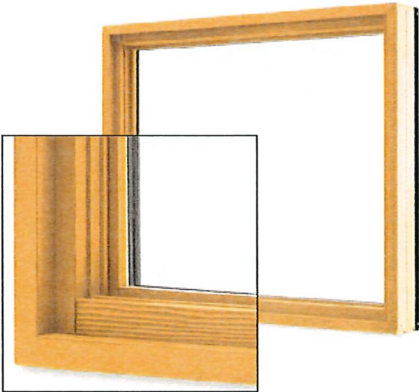

IN-SASH PICTURE WINDOW
INTERIOR VIEW

DIRECT GLAZE

Direct glaze refers to a window with no sash. The glass is glazed directly into the frame and is stationary.

IN-SASH

In-sash Picture windows are non-operable, and they can match the profiles of windows with operable sash.



ULTIMATE SWINGING FRENCH DOOR G2

Inswing French door G2 with Oil Rubbed Bronze hardware

MARVIN SIGNATURE® COLLECTION



Inswing French door G2 and Elevate Direct Glaze window in White with Simulated Divided Lites

ULTIMATE SWINGING FRENCH DOOR G2

The Ultimate Swinging French door G2, available in both Inswing and Outswing, delivers a traditional aesthetic with 4 ¾ inch top rail and 8 ½ inch bottom rail. Select sizes up to 10 feet high and 14 feet wide to maximize views and access to the outdoors. Choose up to 4 panels with an Ogee interior profile.

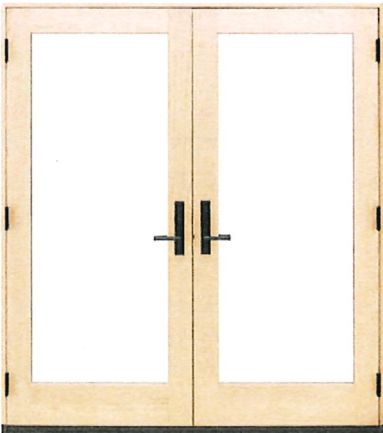

INSWING
INTERIOR



INSWING
EXTERIOR

 Available with IZ3

EXTERIOR FINISH OPTIONS

STONE WHITE

COCONUT CREAM

SIERRA WHITE

CASHMERE

PEBBLE GRAY

HAMPTON SAGE

CADET GRAY

CLAY

CASCADE BLUE

SUEDE

GUNMETAL

WINEBERRY

BRONZE

BAHAMA BROWN

EVERGREEN

EBONY

BRIGHT SILVER (PEARLESCENT)

COPPER (PEARLESCENT)

LIBERTY BRONZE (PEARLESCENT)

CUSTOM COLOR: ANY COLOR YOU WANT

SW 7036

Accessible Beige

FULL DETAILS ▾

Unlike many beiges, this color has undertones of gray that can give your space a warm, snug feel. Pair with earthy tones.

Get this color in a:



Color Sample



Paint Sample



Interior Paint



Exterior Paint

WINDOWS AND DOORS TO BE PAINTED SW7036
(ACCESSIBLE BEIGE)

MARVIN®

EXTRUDED ALUMINUM

Extruded aluminum is an extremely tough cladding that protects wood windows, mimics the profiles of wood, and provides superior durability. It is the most commonly ordered exterior material for our Ultimate products.

Select a color from our palette of 19 durable extruded aluminum colors, including a spectrum of rich hues and three pearlescent finishes. If you have more specialized needs, we can also work with you to create a custom color.

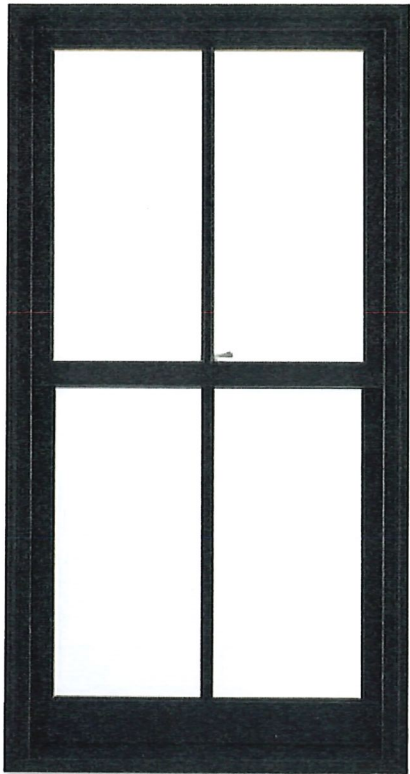

Double Hung G2 window in Ebony

WOOD

Wood is a premium material for windows and doors, offering classic aesthetic appeal, many options for customization, and design versatility.

We treat exposed millwork with a water repellent wood preservative to help it last longer. Choose from one of the four options below. Each is ready to be finished to match your project's exacting requirements.



Double Hung G2 window in Suede

DIVIDED LITES

Simulated divided lites, available in a number of different styles, mimic the look of individual panes of glass with the energy efficiency of dual pane insulated glass.

Our custom capabilities allow us to create almost any divided lite pattern to match your design style.

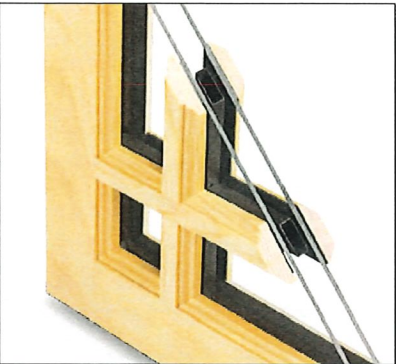

SIMULATED DIVIDED LITE (SDL)
SDL bars are permanently adhered to both sides of the glass. Simulated Divided Lites with Spacer Bars (SDLs) are an energy-efficient way to create the look of authentic divided lites.



AUTHENTIC DIVIDED LITE (ADL)
Separate panes of glass are glazed between muntin bars for historical accuracy. Available exclusively with wood exterior units.

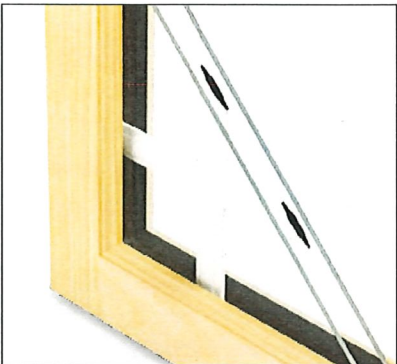

GRILLES-BETWEEN-THE-GLASS (GBG)
Grilles are permanently installed between the glass panes. This low-maintenance grille offers the look of a divided lite pattern with the ease of cleaning just one pane of glass. Available with different interior and exterior colors.

FIVE STANDARD BAR WIDTHS



SQUARE STICKING

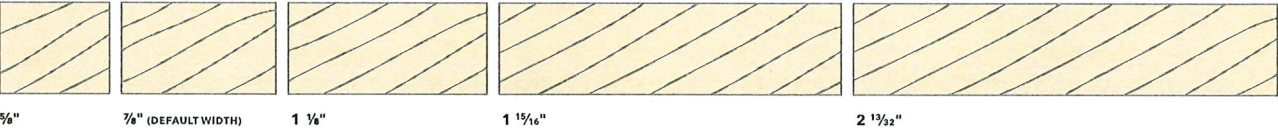

STICKING AND PROFILES

Sticking refers to the interior profiles of your wood window. Choose from the standard Ogee profile (used on traditional projects) or the optional clean, contemporary Square sticking.

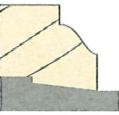

OGEE

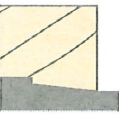

SQUARE



SQUARE STICKING

Craftsman Collection™

The TruExterior Siding Craftsman Collection™ offers a variety of authentic, full-thickness profiles with bold, defined shapes and the natural aesthetic of traditional wood siding, all without the maintenance and upkeep associated with exterior wood products.

Historically and architecturally accurate profiles—Channel, Channel Bevel, Cove/Dutch Lap, Nickel Gap, Shiplap and V-Rustic—are the ideal solution for homeowners who desire the look, feel and character of authentic wood siding while avoiding rotting, excessive swelling and termite attacks.



Pictured Top Left to Right: Channel Bevel, Nickel Gap
Pictured Bottom Left to Right: Nickel Gap, Channel Bevel

SW 7036

Accessible Beige

FULL DETAILS ▾

Unlike many beiges, this color has undertones of gray that can give your space a warm, snug feel. Pair with earthy tones.

Get this color in a:

Color Sample

Paint Sample

Interior Paint



Exterior Paint

REVERSIBLE SHIPLAP-NICKEL GAP

TruExterior Siding & Trim's Reversible Shiplap/Nickel Gap siding panels offer two authentic, on-trend looks in one for increased versatility and convenience. The profile comes in two formats: one features smooth Nickel Gap on one side and woodgrain Shiplap on the other; the second combines woodgrain Nickel Gap with smooth Shiplap on the flip side. A rabbeted edge ensures panels install with authentic spacing depending on which side is installed—the tight joint appearance of Shiplap or the nickel-sized space of Nickel Gap. Four widths are available for 16 total profile combinations.

Finish Options:

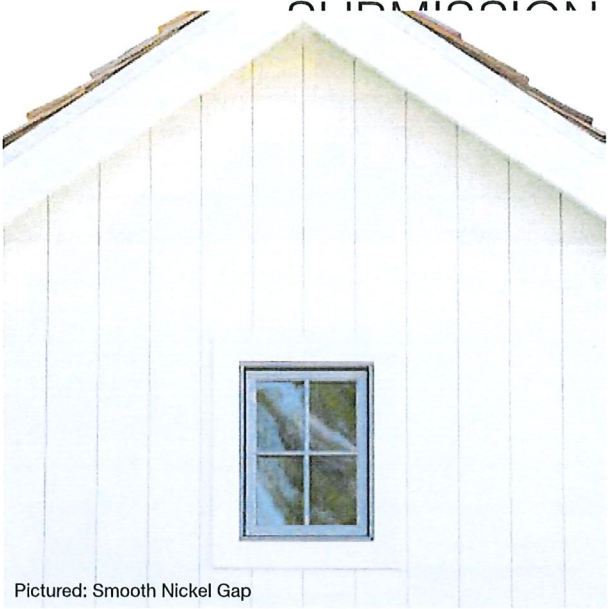
- Smooth Nickel Gap with Woodgrain Shiplap
- Woodgrain Nickel Gap with Smooth Shiplap



Pictured: Smooth Nickel Gap

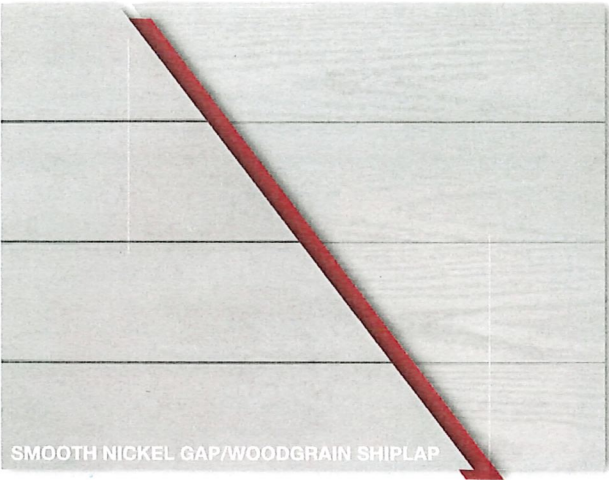

SMOOTH NICKEL GAP/WOODGRAIN SHIPLAP

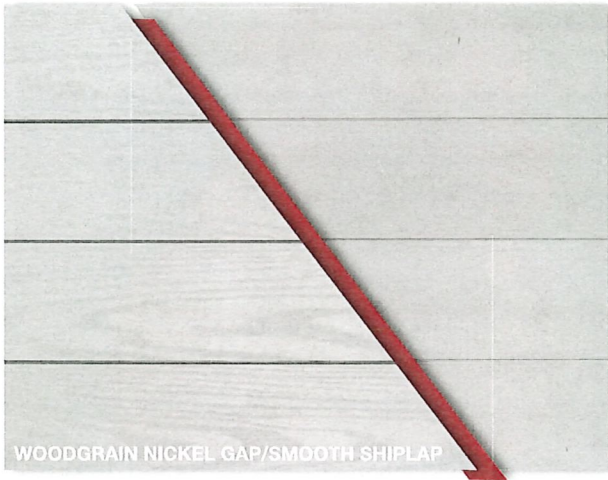

WOODGRAIN NICKEL GAP/SMOOTH SHIPLAP

SHIPLAP GAP SIDE

Nominal Size	Actual Thickness (A)	Actual Width (B)	Reveal (C)
1 x 4	11/16"	3-1/2"	3-3/32"
1 x 6	11/16"	5-1/2"	5-3/32"
1 x 8	11/16"	7-1/4"	6-13/16"
1 x 10	11/16"	9-1/4"	8-13/16"

NICKEL GAP SIDE

Nominal Size	Actual Thickness (A)	Actual Width (B)	Reveal (C)	Gap (D)
1 x 4	11/16"	3-1/2"	3-3/32"	5/64"
1 x 6	11/16"	5-1/2"	5-3/32"	5/64"
1 x 8	11/16"	7-1/4"	6-13/16"	5/64"
1 x 10	11/16"	9-1/4"	8-13/16"	5/64"

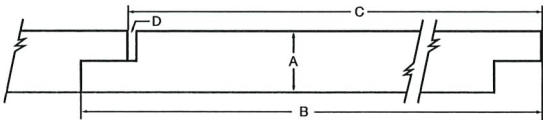
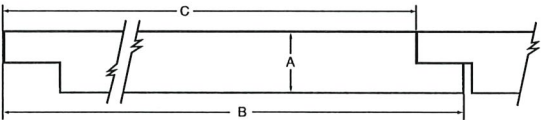

TruExterior Siding comes pre-primed and does require paint.

Trim

Designed to be used in non-load-bearing applications, TruExterior Trim is suitable for ground and masonry contact and moisture-prone areas, which makes it ideal for exterior trim applications such as fascia, door trim, soffits, rake boards and a variety of other applications. There is no need to prime ends or field cuts. Plus, it can be painted any color. TruExterior Trim accepts common high-quality, exterior-grade fasteners and can be installed using standard woodworking tools and methods.



5/8 Trim Sizes		1X Trim Sizes		5/4 Trim Sizes		2X Trim Sizes	
Nominal	Actual	Nominal	Actual	Nominal	Actual	Nominal	Actual
—	—	—	—	—	—	2 x 2	1-1/2" x 1-1/2"
—	—	1 x 3	3/4" x 2-1/2"	5/4 x 3	1" x 2-1/2"	—	—
5/8 x 4	5/8" x 3-1/2"	1 x 4	3/4" x 3-1/2"	5/4 x 4	1" x 3-1/2"	2 x 4	1-1/2" x 3-1/2"
—	—	1 x 5	3/4" x 4-1/2"	5/4 x 5	1" x 4-1/2"	—	—
5/8 x 6	5/8" x 5-1/2"	1 x 6	3/4" x 5-1/2"	5/4 x 6	1" x 5-1/2"	2 x 6	1-1/2 x 5-1/2"
5/8 x 8	5/8" x 7-1/4"	1 x 8	3/4" x 7-1/4"	5/4 x 8	1" x 7-1/4"	2 x 8	1-1/2" x 7-1/4"
5/8 x 10	5/8" x 9-1/4"	1 x 10	3/4" x 9-1/4"	5/4 x 10	1" x 9-1/4"	2 x 10	1-1/2" x 9-1/4"
5/8 x 12	5/8" x 11-1/4"	1 x 12	3/4" x 11-1/4"	5/4 x 12	1" x 11-1/4"	2 x 12	1-1/2" x 11-1/4"

TruExterior Trim is reversible with woodgrain on one side and a smooth finish on the reverse. Available in a 16' length.

Reversible Smooth/Woodgrain Finish

SW 7036

Accessible Beige

FULL DETAILS

Unlike many beiges, this color has undertones of gray that can give your space a warm, snug feel. Pair with earthy tones.

Get this color in a:



Color Sample



Paint Sample



Interior Paint



Exterior Paint

TIMBERLANE
PANEL SHUTTERS
Timeless, Classic Appeal

Choose From 18 Profiles

Timberlane's Panel shutters feature timeless details that have been cherished by many for hundreds of years. From raised and recessed to shaker and flat panel options, there is a surefire shutter style to suit your home's aesthetic. Timberlane uses a craftsman-quality tongue and groove construction to secure the edge of the trim inside the shutter frame, ensuring a snug, long-lasting fit.

Choose from our available panel shutter styles or design your own. If you can dream it, we can build it.

PANEL SHUTTER CUSTOMIZATION OPTIONS

STYLES: Raised Panel, Recessed Panel, Flat Panel

MATERIALS: Endurian®, Premium Wood

Don't see the custom option you want?
Call us at 800-250-2221

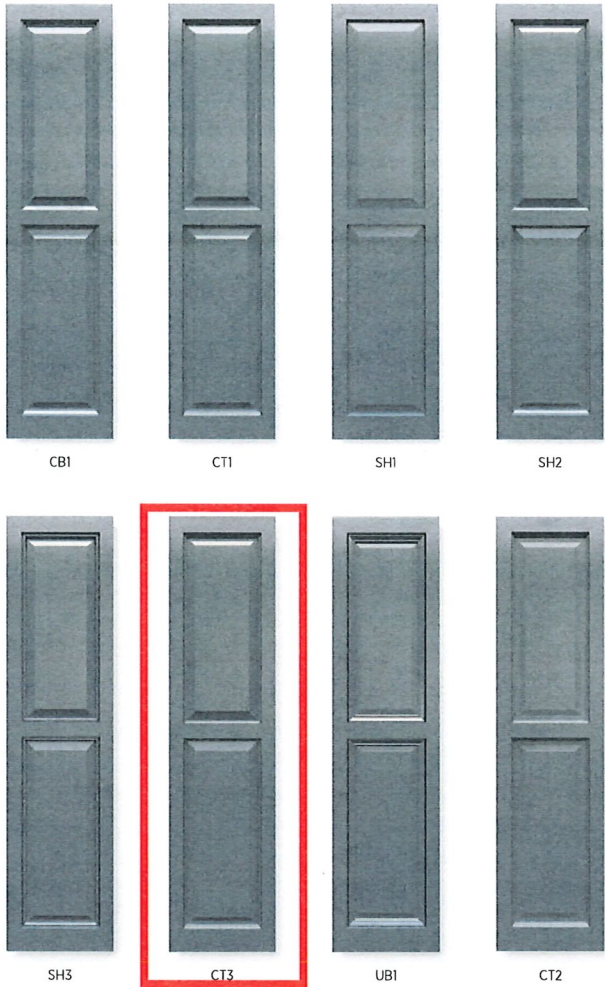

6

Luxurious Finishes to Suit Your Style

Your shutter color can have a tremendous impact on your home's overall look, and with Timberlane's color-matching capability, the options are endless! Whether you desire a bold color like Really Red or the classic look of Pitch Black, your shutters will be treated with our multi-step paint process, giving them a vibrant and long-lasting finish.

CHOOSE FROM 24 PREMIUM PAINT COLORS†



SHUTTERS TO MATCH
EXISTING HISTORIC STYLE

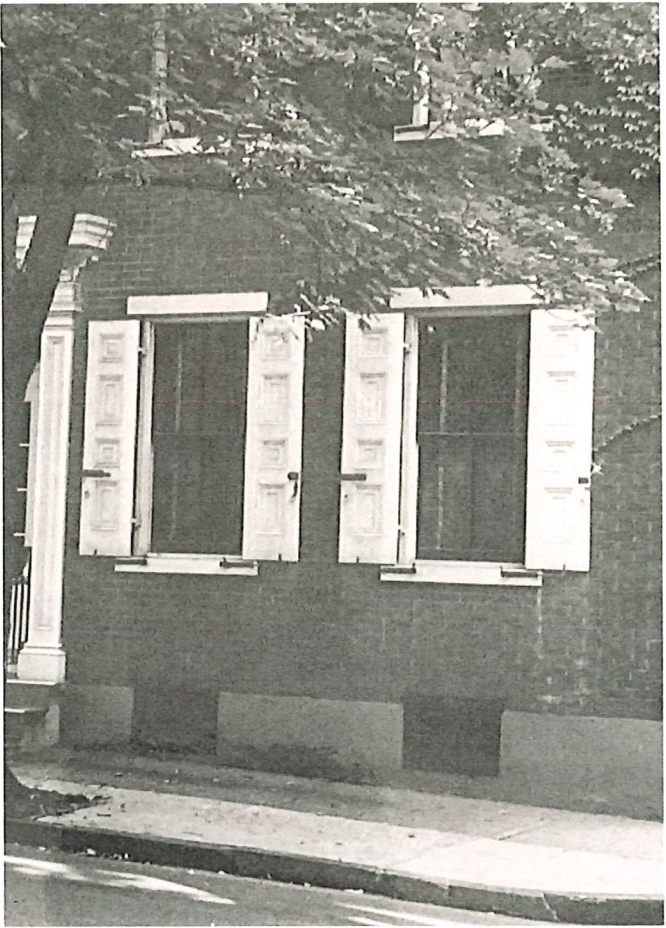

Exacting Details. Endless Possibilities

Timberlane's Endurian and Premium Wood shutter materials can be crafted in any of the configurations shown below. Our dedicated team of artisans strives to design your shutters with precision and care. Whether your order requires custom cutouts, operable louvers, or arch top shutters for arch top windows, Timberlane has the skill to perfectly execute even the most ambitious of projects, and the commitment to quality to get the job done right.

CHOOSE YOUR CONFIGURATION*

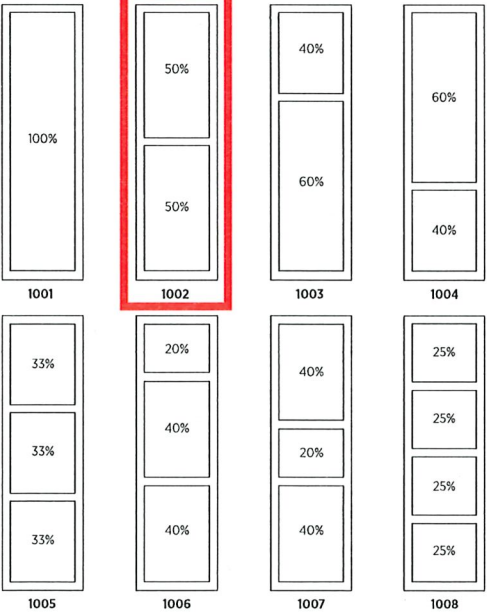

We build every order to precise specifications and can create replacement shutters that match your existing set.

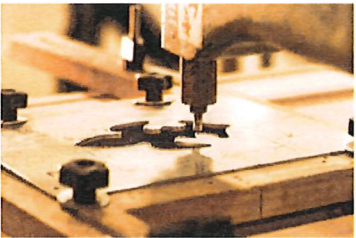

Add an extra touch of style with one of our many cutout designs.



Customers have the option to match the profile, configuration, and color to doors and other design elements. This home's door and shutter colors were custom-matched, though the shutter configuration (1002 or 50/50) differs from the door paneling.

†Please be aware that color variations in monitors, printer settings, and lighting sources are not consistent across all mediums and therefore may not be a true representation of the exact color as shown above.

*Premium color option is not available for Timberlane's Resilience Shutter Material.

Specifications
Timberlane Shutters



Product Overview

Glen-Gery thin brick is the pinnacle of form and function. With a striking appearance, its style is just as convincing as its strength. Whether you take it inside or outside, thin brick has the pull to be the centerpiece. Glen-Gery thin brick is a compelling alternative developed to give architects, engineers, builders and homeowners a choice that expands their design potential.



Details

Suggested use: interior and exterior applications including accent walls, kitchens, bar surround, backsplashes, archways, fireplaces and more!

See the next few pages for color options, or visit www.glen-gery.com



Sizes

Thin brick come in a variety of sizes. The following pages showcase the current thin brick offering. Virtually any of our full size facebrick can be cut into thin brick to meet project needs. Please refer to the actual dimensions listed above the products on each page. Contact your Glen-Gery sales representative for more information.

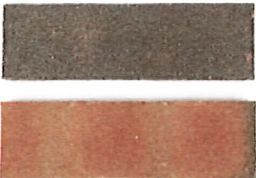

Flats



Corners

Cushwa

- M
- S
- ES
- TB

MID-ATLANTIC • Catalog size: Modular Thin Brick (3/4" x 2-1/4" x 7-5/8" | 6.86 brick per sqft),
* Engineer Standard Thin Brick (3/4" x 2-3/4" x 8" | 5.36 brick per sqft)



1-HB



47-HB

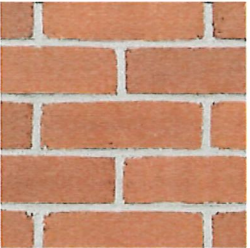

56-DD

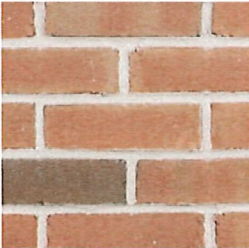

Georgian



Shenandoah "1776" *



53-DD



52-DD

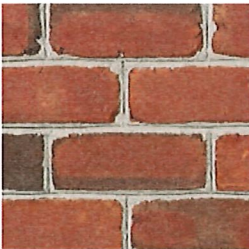

53-DD "1776" *



Specifications
Glen-Gery Brick

NATURAL METAL *collection*



URBAN SLATE

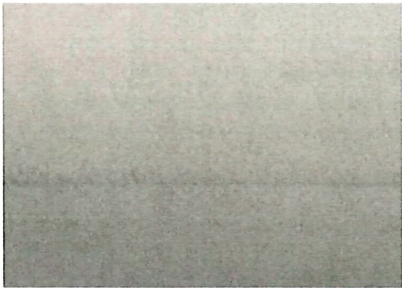

VINTAGE[®]



DREXLUME™

LOW GLOSS *collection*

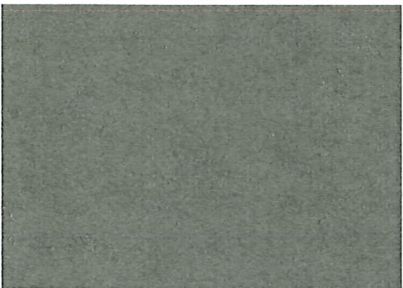

NANTUCKET GRAY

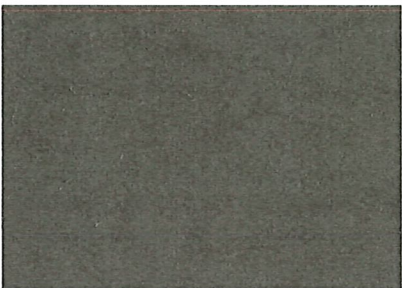

ASPEN BRONZE



CHESTNUT BROWN

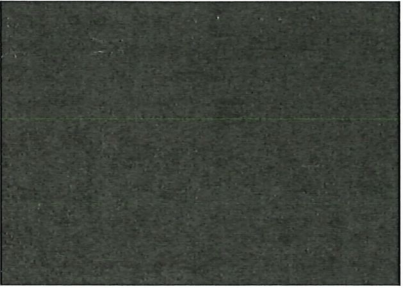

CLASSIC BRONZE



MIDNIGHT GREEN



PINE

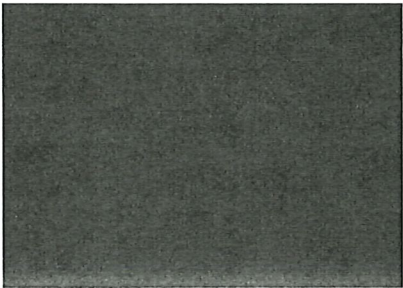

INKWELL



TRADITIONAL BLACK

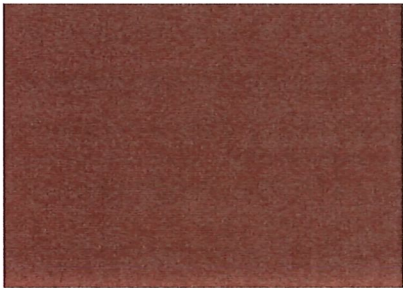

AUTUMN RED



ANTIQUE METAL

SPECIAL PRINT *premium*



Updated February 2022



HAND CRIMPED STANDING SEAM

