

# CITY OF BETHLEHEM, PENNSYLVANIA CODE BOARD OF APPEALS

## APPLICATION FOR APPEAL SUBMIT \$100.00 FEE & ORIGINAL PLUS (6) COPIES

PROPERTY ADDRESS 201 East Packer Ave.

OWNER Lehigh University PHONE [REDACTED]

OWNER'S ADDRESS 27 Memorial Drive

APPLICANT Quadratus CM / Jim Eck PHONE [REDACTED]

APPLICANT'S ADDRESS 306 S. New Street, Suite 605

APPLICANT'S EMAIL [REDACTED]

### REASON FOR APPEAL:

- The true intent of the Act or Uniform Construction Code was incorrectly interpreted.
- The provisions of the Act do not apply.
- An equivalent form of construction is to be used.
- Extension of time.

List section(s) of the Act which are being appealed and a brief description of remedy sought.

IBC 2015 Section 1002.6 states that Building (House) traps shall be prohibited. With that in mind, we request that the City requirement be waived as all fixtures in the building are trapped.

Signature  President Date 3/31/22

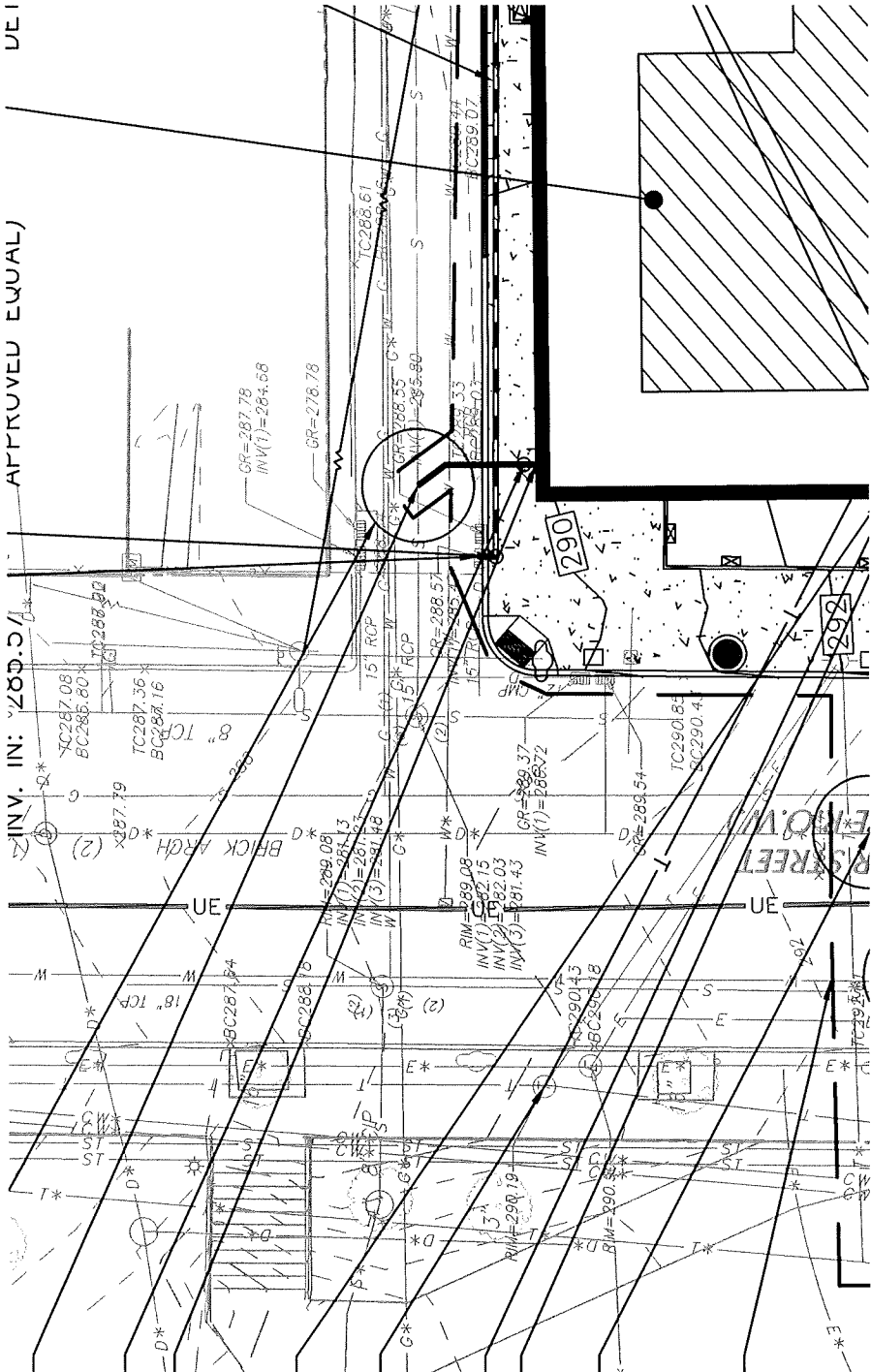

APPROVED EQUAL)

DEI

APPROXIMATE TIE IN  
ELEVATION: 282.77 (VIF)

CLEANOUT, TYP.

6" PVC SANITARY LATERAL (BACKFLOW  
PREVENTER TO BE PROVIDED AT BUILDING)  
INV: 283.50

PROPOSED 8" PVC STORM  
PIPE  
INV: 287.34

APPROXIMATE INCOMING TELECOM LINE  
(CONTRACTOR TO CONFIRM EXISTING  
UNDERGROUND UTILITY LOCATIONS)

CLEANOUT, TYP.

KFLOW PREVENTER LOCATION (REFER TO  
DETAIL ON SHEET CS-3.1)

APPROXIMATE TIE IN ELEVATION:  
285.52 (CONTRACTOR TO PERFORM  
VACUUM EXCAVATION TO CONFIRM  
EXISTING PIPE ELEVATION)

CONFIRM 10" WATER MAIN (CONTRACTOR TO  
CONFIRM EXISTING UNDERGROUND UTILITY  
LOCATION)

